

# STR Caster™

## Specification Guide for Stabilizer & Rigid Casters

Make & Model Cross Reference

OEM Part Number Cross Reference

Caster Specification Cross Reference

Caster Kit Replacement Parts Diagram

Features & Benefits of  
STR 1000, 2000, 5200, 5400, & 4100 Series

Maintenance Log



**SUPERIOR**  
TIRE & RUBBER CORP.  
MATERIAL HANDLING COMPONENTS

**ENGINEERING REVOLUTION™**

1.800.289.1456

1.814.723.2370

fax 1.814.726.0740

[www.SuperiorTire.com](http://www.SuperiorTire.com)

# STR Stabilizer Caster™ to Make/Model Cross Reference

<b>STR1500</b>	<b>Hyster</b> W40Z W50Z W45Z	<b>Yale</b> MPB040 MPW045			
<b>STR1600 Series</b>	<b>Raymond</b> 8210 8310				
<b>STR2000</b>	<b>Baker</b> BWR EWR	<b>CAT</b> NPV series WR8000	<b>Crown</b> PE 40-80 PC 3000 PC 40-80 PW 40-80	<b>Hyster</b> W40XT W40CL WR series B40CL W40-60XL B40XL W/B/C 40-60 BL/BF	<b>Prime Mover</b> SN20-40 SR 30 PE 60W JT 60C PX 40 MX 50 RX 50-65 PE 40-65 DLR65
<b>STR2000BL</b>	<b>Linde/Baker</b> EWR80 EWR60 R20 EWR2692				
<b>STR2000CR2</b>	<b>Crown</b> PE4000-6000				
<b>STR2000HY</b>	<b>Hyster</b> B80Z,B60Z R30CH	<b>Yale</b> MPE060LE/LF,VG MPE080LE/LF,VG			
<b>STR2000JH</b>	<b>CAT</b> WR6000	<b>Jungheinrich</b> ECR327 ECR336			
<b>STR2000RA</b>	<b>Raymond</b> 114 810 19-F60L	<b>Raymond</b> 8400 8500 8600	<b>Toyota</b> 8HBE30		
<b>STR2000TY</b>	<b>CAT</b> NPV60				
<b>STR3000</b>	<b>Barrett</b> WRP 60-80	<b>Hyster</b> W60-80XT B40-80XT C60-80XT	<b>Yale</b> MLW/E MP/W/E/C MP040-060		
<b>STR4000</b>	<b>Clark</b> HWD, SSX	<b>Crown</b> 60PE			
<b>STR4100 Series</b>	<b>Unicarriers</b> SPX Series				
<b>STR5200 Series</b>	<b>Crown</b> PE4000 PE4500	<b>Hyster</b> B60Z B60ZAC B60ZHD B80Z	<b>Yale</b> MPE060LE/LF,VG MPE080LE/LF,VG	<b>Unicarriers</b> RPX Series	
<b>STR5400 Series</b>	<b>Clark</b> HWX30 HWX40	<b>Crown</b> PR4500			

# STR Stabilizer Caster™ to OEM Part Number Cross Reference

<b>STR1500 Series</b>	<b>Hyster</b> 2044852					
<b>STR1600 Series</b>	<b>Raymond</b>	<b>Yale</b> 580023164				
<b>STR2000</b>	<b>Baker</b>	<b>CAT</b>	<b>Crown</b>	<b>Hyster</b>	<b>Prime Mover</b>	<b>Raymond</b>
	127520	1009237	843611	2007884	139312	671-017
	138071	1009299	843613	3246410	27332	671-023
	138073	1202032	843614	323772	27675	671-024
	138075		843616	346202	27849	671-025
	139312	<b>Crown</b>	84361001	351314		671-026
	993465	76546	84361003	526120	<b>Mitsubishi</b>	
	993994	310273	84361006	826275	NA067022	<b>Toyota</b>
	152865	81270	82694001			00590-00027-71
	153858	826941	82694002	<b>Larcaster</b>	<b>RVI</b>	42660-81100-71
		826942	82694003	LC2000/2500	0951-C01	
		826943	82694004			<b>Yale</b>
		826944				1501200-33
	826946					
<b>STR2000BL</b>	<b>Linde/Baker</b> 154148					
<b>STR2000CR2</b>	<b>Crown</b>	<b>Larcaster</b> LC2400				
	129929-001					
	133109-001					
<b>STR2000HY</b>	<b>Hyster</b>	<b>Yale</b>				
	346201	524244220				
	2079240	524267533				
<b>STR2000JH</b>	<b>Jungheinrich</b>	<b>Jungheinrich</b>				
	W205012772	S0440054				
<b>STR2000RA</b>	<b>Raymond</b>	<b>Raymond</b>				
	59043168	59048553				
	1082408	671-042				
<b>STR2000TY</b>	<b>CAT</b> NA014895 217384					
<b>STR3000</b>	<b>Barrett</b>	<b>Hyster</b>	<b>Larcaster</b>	<b>Toyota</b>	<b>Yale</b>	<b>Yale</b>
	43380-FS1000/1/2	2308415 2311685	LC3001-350	00590-01556-71 00590-01662-71 00590-39633-71	516012603 518782600 520583002	720465006 524153612
<b>STR4000</b>	<b>Clark</b>	<b>Clark</b>			<b>Crown</b>	<b>Larcaster</b>
	1779711	2789890			76546	LC4001/4501
	2314632	2779621				
	2314636	2786022				
	2743452					
<b>STR4100 Series</b>	<b>Crown</b>	<b>Raymond</b>	<b>Unicarriers</b>			
	310260	2832879	43380-FS400 43380-FS401			
<b>STR5200 Series</b>	<b>Crown</b>	<b>Hyster</b>	<b>Yale</b>	<b>Unicarriers</b>		
	129929-001	316201	524244220	43380-FS005		
	133109-001	2072940	524267533			
<b>STR5400 Series</b>	<b>Clark</b>	<b>Crown</b>				
	2832879	310265				

# STR Stabilizer Caster™ Kit Selection Diagram

## NOTE:

*This model is based off of the STR2000 Stabilizer Caster. Patented design & components. US Patent #6,425,161 B1 for the industrial caster wheel & PolyBlock™ shock absorbing mechanism, & US Patent #7,093,319 B2 for the adjustment member of the caster.*

\*Adjustment Set Screw and Adjustment Jam Nut are included in the Complete Bolt Kit and the Housing Kit.

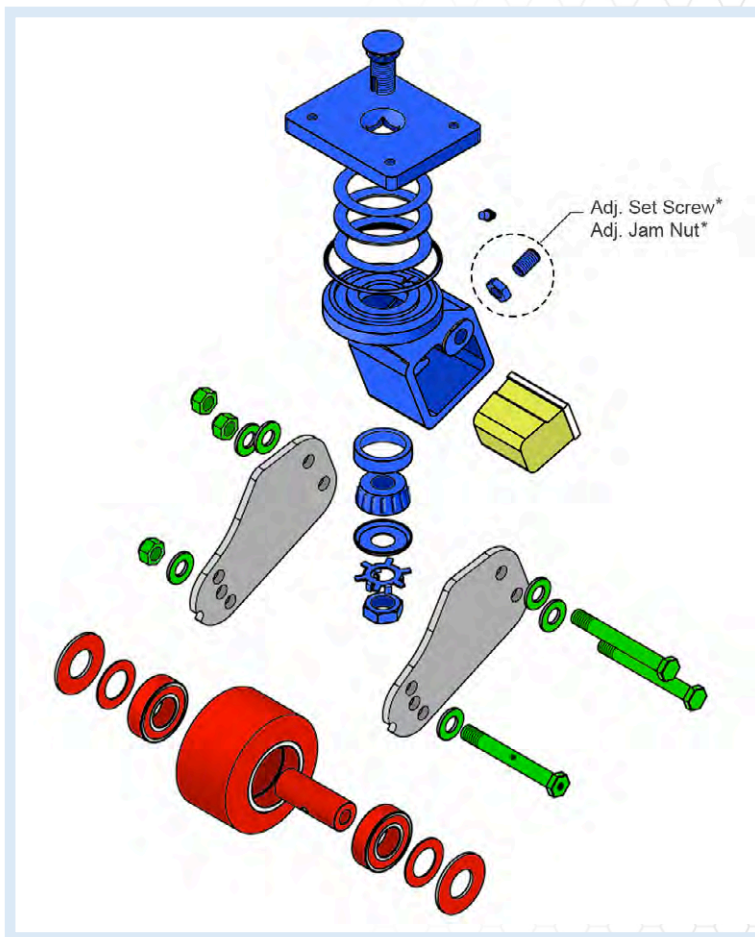

## Complete Bolt Kit

Included Parts	Quantity
Bolt	2
Greasable Axle	1
Washers	6
Nylock Nut	3
Adj. Set Screw	1
Adj. Jam Nut	1

## Housing Kit

Included Parts	Quantity
Mount Plate	1
King pin, washer, nut	1
Upper Olite Bearings	1
Caster Housing & Zerk	1
Adj. Set Screw	1
Adj. Jam Nut	1
Lower Timken Cup & Cone Bearing parts	1

## Wheel Kit

Included Parts	Quantity
Load Wheel	1
Axle Bushing	1
Bearings	2
Washers	2
String Guards	2

# STR Stabilizer Caster™ Dimensions

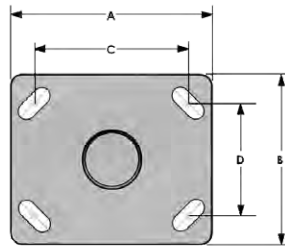
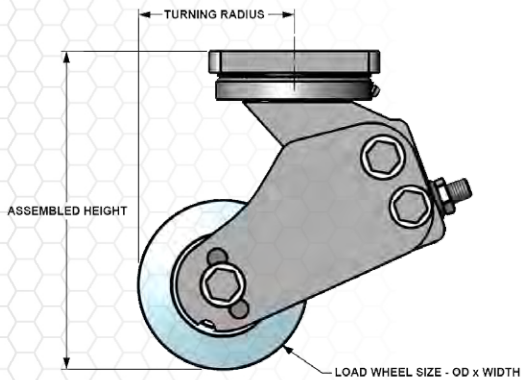

BASE PLATE SIZE = A x B

BOLT PATTERN = C x D

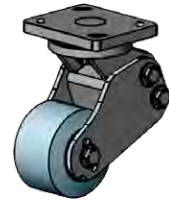

Model	Series	Assembled Height (in)	Turning Radius (in)	Centered or Offset Swivel	Load Wheel Size(in)	Base Plate Size(in)	Slots or Holes	Bolt Pattern
STR1500	STR1000	5.5	3.3125	Offset	3.25 x 1.57	3.15 x 4.587	Threaded Holes	3 Hole
STR1638	STR1000	5.5	3.3125	Centered	3.25 x 2	3.5 x 3.5	Holes	2.5 x 2.5
STR2000	STR2000	7.5	4.1875	Centered	4 x 2.5	4 x 4.75	Slots	3.992 x 3.004
STR2000BL	STR2000	7.5	3.875	Centered	4 x 2.5	3 x 4.75	Holes	2.756 x 3.385
STR2000CR2	STR2000	7.5	4.1875	Centered	4 x 2.5	5 x 5	2-Sets of Holes	2.625 x 3.625 and 4.125 x 4.125
STR2000HY	STR2000	7.5	4.1875	Centered	4 x 2.5	4 x 4.5	Threaded Holes	2.795 x 3.295
STR2000JH	STR2000	7.875	3.625	Offset	4 x 2.5	4.25 x 5.5	Threaded Holes	3.125 x 4.125
STR2000RA	STR2000	7.5	4.1875	Offset	4 x 2.5	5 x 6	Holes	3 x 5
STR2000TY	STR2000	7.5	4.1875	Centered	4 x 2.5	4 x 5.75	Holes	3 x 5
STR2100	STR2100	8.375	4.1875	Centered	4 x 2.5	4 x 4.5	Threaded Holes	2.795 x 3.295
STR3000	STR3000	9.125	4.1875	Centered	4 x 2.5	5 x 7	Slots	3 x 5
STR3002	STR3000	9.125	4.1875	Centered	5 x 2.5	5 x 7	Slots	3.328 x 5.269
STR5213	STR5200	8.07	4.125	Centered	4 x 2.5	4 x 4.5	Holes	2.795 x 3.295
STR5253	STR5200	7.75	4.5	Centered	4 x 2.5	5 x 5	2-Sets of Holes	2.625 x 3.625 and 4.125 x 4.125
STR5263	STR5200	8.85	4.442	Centered	4 x 2.5	5 x 7	Holes	3.375 x 5.25
STR5453	STR5400	7.51	4.125	Centered	4 x 2.5	5.25 x 5.25	2-Sets of Holes	2.625 x 3.625 and 4.125 x 4.125
STR5473	STR5400	8.189	3.793	Centered	4 x 2.5	5.25 x 5.25	Holes	4 x 4
<b>Rigid Swivel Caster</b>								
STR4163	STR4100	8	4.684	Centered	6 x 3	4.5 x 6.25	Holes	3.375 x 5.25

# STR Stabilizer Caster™

## The Newest Technology in Stabilizer Casters

### STR1000 Series Caster

For 4,500lb Pallet Trucks

Engineered for walk-behind pallets trucks carrying 4,000-5,000lb loads. Designed with a full size swivel mechanism for added strength and longer wear-life. Features a PolyBlock™ dampener for consistent performance throughout the life of the caster.



#### Full Size Swivel

Using cup and cone with thrust bearing instead of single row ball bearing ensures high durability and longer wear-life.

#### Fine & Convenient Height Adjustments

Extra-fine adjustments eliminating the use of spacers and shims

#### Durable Duty Steel Construction

0.25" steel plates with no welds to reduce weak points

#### Greater Cornering Stability & Comfort

Patented PolyBlock™ damper technology reduces oscillation and rocking effect

#### Immediate Availability

Designed and manufactured in-house, we stock and service all assemblies and replacement parts

#### Reliable and Consistent Performance

Less height and performance deterioration over time than metal springs

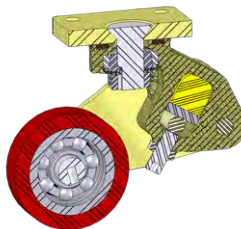

#### Standard Features

- Rust Proof Zinc Plating
- Greasable Wheel Axle
- Available for: STR1500, STR1638

#### Extreme Food Service

- In addition to standard features

- Greasable Pilot Axle
- Larger Greasable Wheel Axle
- Available for STR1500 caster models

#### Superior Select Availability

(Same or Next Business Day Shipping)

- ◇ String Guard comes standard
- ◇ Linear Deflection with a positive stop after 1"
- ◇ Interchangeable kit replacements available for all models
- ◇ Optional maintenance-free, Sealed Wheel Bearings
- ◇ Optional Wheel compounds:
  - Cushothane® EZ™
  - Cushothane® XL™

# STR Stabilizer Caster™

## The Newest Technology in Stabilizer Casters

### STR2000 Series Caster

For 6,000lb Rider Pallet Trucks

**Engineered as a drop-in replacement for all OEMs, the STR Stabilizer Caster™ - with patented PolyBlock™ technology - eliminates the use of unreliable metal springs yet provides greater stability in cornering, a smoother ride and higher productivity.**



#### Durable Steel Construction

0.25" steel plates with no welds to reduce weak points

#### Fine & Convenient Height Adjustments

Easy three-position coarse & extra-fine adjustments eliminating the use of spacers and shims

#### Longer Wheel Work-Life and Protected in All Environments

By using a larger wheel (4" O.D.) with the toughest polyurethane compound available with Rust-Proof Zinc plated parts and a greasable wheel or axle for corrosive environments

#### Greater Cornering Stability & Comfort

Patented PolyBlock™ damper technology reduces oscillation and rocking effect

#### Immediate Availability

Designed and manufactured in-house, we stock and service all assemblies and replacement parts

#### Reliable and Consistent Performance

Less height and performance deterioration over time than metal springs

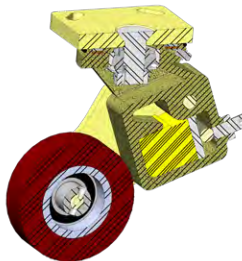

#### Standard Features

- Rust Proof Zinc Plating
- Greasable Wheel Axle
- Available for: STR2000, STR2000BL, STR2000CR2, STR2000HY, STR2000JH, STR2000RA and STR2000TY

#### Extreme Food Service

- Greasable Pilot Axle
- Larger Greasable Wheel Axle
- Available for STR2000HY, STR2000JH, and STR2000TY caster models

#### Superior Select Availability

(Same or Next Business Day Shipping)

◇ *String Guard comes standard*

◇ *Linear Deflection with a positive stop after 1.5"*

◇ *Interchangeable kit replacements available for all models*

◇ *Optional maintenance-free, Sealed Bearings*

◇ *Optional Wheel compounds:*

- Cushothane® EZ™
- Cushothane® XL™

# STR Stabilizer Caster™

## The Newest Technology in Stabilizer Casters

### STR5200 Series Caster

Side Adjustable for 6,000lb Rider Pallet Trucks

Designed to be quickly and easily adjustable from the side of the truck, without ever having to lift the truck. Solid casting with no welds and thicker 5/16" side plates for added strength and longevity. Also features patented PolyBlock™ dampener technology.

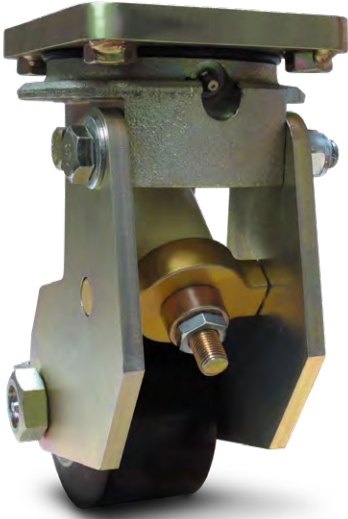

#### Heavy Duty Steel Construction

Solid casting without welds and heavy duty 5/16" side plates

#### The Easiest/Fastest Height Adjustable Caster Available

Achieve the perfect height using a typical wrench with our linear fine thread adjusting mechanism - without lifting the truck

#### Longer Wheel Work-Life and Protected in All Environments

By using a larger wheel (4" O.D.) with the toughest polyurethane compound available with Rust-Proof Zinc plated parts and a greasable wheel or axle for corrosive environments

#### Greater Cornering Stability & Comfort

Patented PolyBlock™ damper technology reduces oscillation and rocking effect

#### Immediate Availability

Designed and manufactured in-house, we stock and service all assemblies and replacement parts

#### Reliable and Consistent Performance

Less height and performance deterioration over time than metal springs

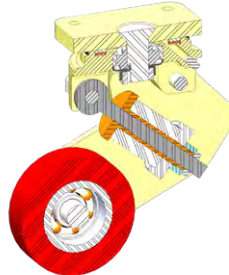

#### Standard Features

- Rust Proof Zinc Plating
- Greasable Wheel Axle
- Available for: STR5213, STR5253, STR5263, STR5200B

#### Superior Select Availability

(Same or Next Business Day Shipping)

◇ String Guard comes standard

◇ Linear Deflection with a positive stop after 2 inches

◇ Interchangeable kit replacements available for all models

◇ Optional maintenance-free, Sealed Wheel Bearings

◇ Optional Wheel compounds:

- Cushothane® EZ™
- Cushothane® XL™





# STR Stabilizer Caster™

## The Newest Technology in Stabilizer Casters

### STR5400 Series Caster

Side Adjustable for 8,000lb Rider Pallet Trucks

Designed as a heavier duty quick and easy adjustable from the side of the truck caster. Kingpin-less heavy duty machined & hardened cast housing with no welds and heavy duty 3/8" side plates for added strength and longevity. Features patented PolyBlock™ dampener technology.

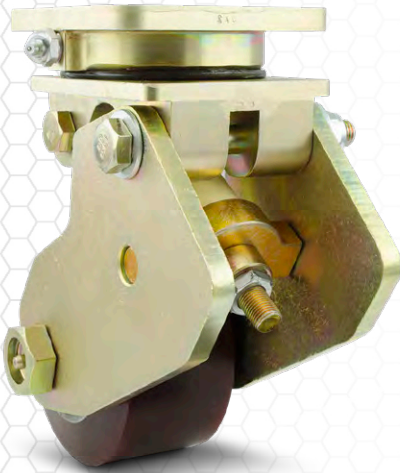

#### Heavy Duty Steel Construction

Hardened machined cast upper & lower housing with no welds and heavy duty 3/8" side plates

#### The Easiest/Fastest Height Adjustable Caster Available

Achieve the perfect height using a typical wrench with our linear fine thread adjusting mechanism - without lifting the truck

#### Longer Wheel Work-Life and Protected in All Environments

By using a larger wheel (4" O.D.) with the toughest polyurethane compound available with Rust-Proof Zinc plated parts and a greasable wheel or axle for corrosive environments

#### Greater Cornering Stability & Comfort

Patented PolyBlock™ damper technology reduces oscillation and rocking effect

#### Immediate Availability

Designed and manufactured in-house, we stock and service all assemblies and replacement parts

#### Reliable and Consistent Performance

Less height and performance deterioration over time than metal springs

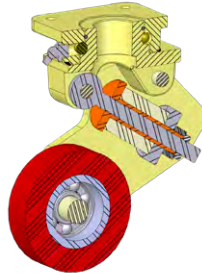

#### Standard Features

- Rust Proof Zinc Plating
- Greasable Wheel Axle
- Available for: STR5453, STR5473

#### Superior Select Availability

(Same or Next Business Day Shipping)

◇ *String Guard comes standard*

◇ *Linear Deflection with a positive stop after 2 inches*

◇ *Interchangeable kit replacements available for all models*

◇ *Optional maintenance-free, Sealed Wheel Bearings*

◇ *Optional Wheel compounds:*

- Cushothane®
- Cushothane® XL™



# STR Caster™

## Kingpin-less Rigid Swivel Caster

### STR4100 Series Rigid Caster

For Heavy Duty Material Handling Equipment

Designed primarily as a robust rigid caster for heavy duty material handling carts, trucks and rigging equipment, the STR4100 Series excels where others fail. With a solid steel cast housing, no fasteners to break, and hardened steel bearing race, it's aisles ahead of the competition.



#### Heavy Duty Steel Construction

Solid casting without welds and heavy duty kingpin-less swivel mechanism.

#### Convenient Greasability

Greasing moving parts is critical to prolonging work-life. With conveniently located grease fittings, basic maintenance is even easier.

#### Longer Wheel Work-Life from a Large Load Wheel

By using a large 6" OD wheel with the toughest polyurethane compounds available, and a 3" wide cross section provides extreme durability and optimal load capacity.

#### Consistently Smooth Swivel

Specially designed with a hardened steel bearing race uses rubber O-rings to lock out moisture & debris, and lock in grease.

#### Sealed Bearings & String Guards

Preventing debris from binding up the load wheels while maintaining internal lubrication.

#### Zero Fasteners

Factory assembled with no fasteners to eliminate the burden of nut & bolt weaknesses.

#### Standard Features

- Rust Proof Zinc Plating
- Greasable Wheel Axle
- 8" Standard Height
- Available for: STR4163 & STR4164

#### Superior Select Availability

(Same or Next Business Day Shipping)

- ◇ String Guard comes standard
- ◇ Optional maintenance-free, Sealed Wheel Bearings
- ◇ Optional Wheel compounds:
  - Cushothane®
  - Cushothane® XL™

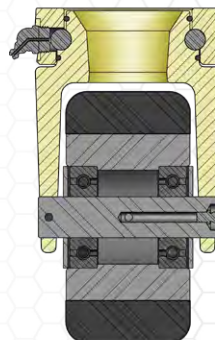

# Caster Maintenance Log

Truck ID / Equipment	Caster Model	Date Checked	Action Required	Action Completed Date	Mechanic/ Inspector

# Superior Tire & Rubber Corp.

40 Scientific Rd.  
Warren, PA 16365

1.800.289.1456 [www.SuperiorTire.com](http://www.SuperiorTire.com)