

E-CO FLEX SEALMATIC

AUTOMATIC RANDOM CASE SEALER FOR E-COMMERCE

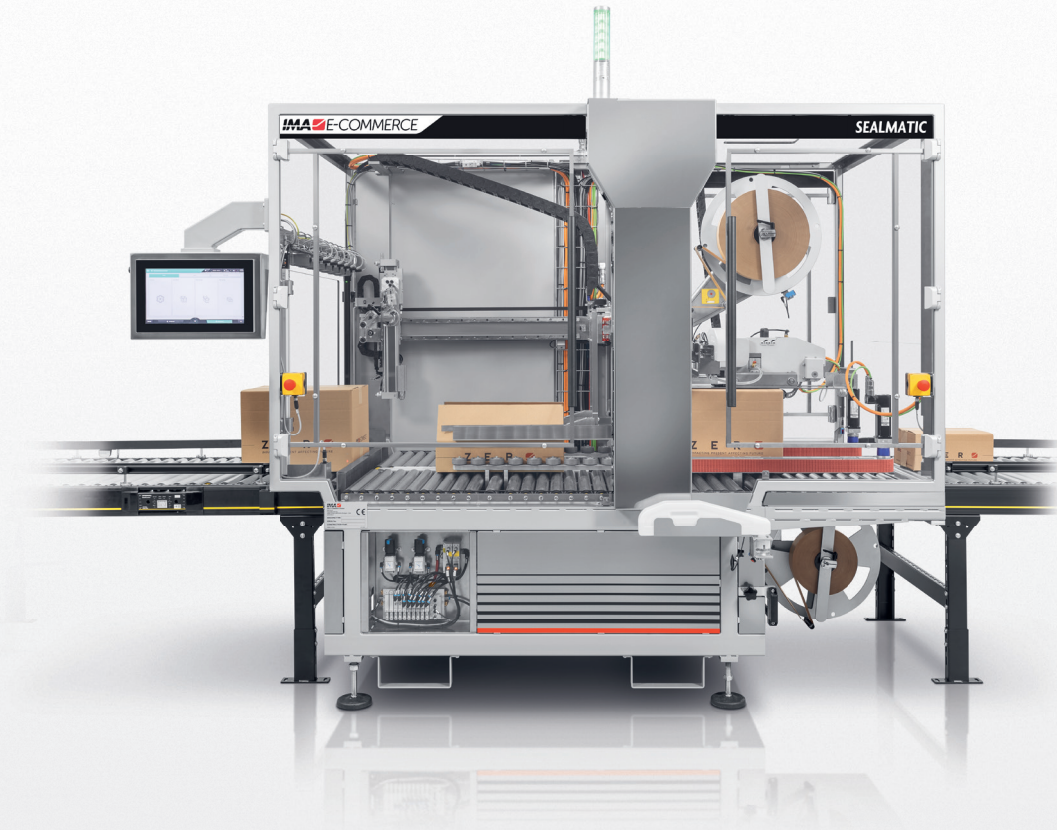

E-CO Flex SealMatic is a fully automated case sealer to process **FEFCO 201 boxes**, automatically adjusting its mechanical movements according to the case size. It is equipped with **sustainable water-activated tape technology** to seal cases on top and bottom at high speed, up to 20 boxes per minute, without the need for operator intervention.

The machine is capable to process an **extensive range of case sizes**, allowing the equipment to seamlessly adjust the closing of the case flaps. In case a SIOC (Ships In Own Container) case is recognized, the machine can bypass it without taping.

Several additional features can be equipped on the machine, such as the application of hazardous materials (hazmat) labels, print&apply of shipping labels, quality inspection smart cameras to verify correct flap folding, taping application and tape leg length.

Thanks to its small footprint, the case sealer can be easily integrated within existing layouts with minor modifications.

MAIN FEATURES

- UP TO 20 CASES PER MINUTE
- BYPASS FUNCTION FOR SIOC CASES
- WIDE RANGE OF CASE SIZES AVAILABLE
- SUSTAINABLE WATER-ACTIVATED TAPE TECHNOLOGY
- HAZMAT LABELS AND/OR SHIPPING LABELS AS OPTION
- SMART CAMERAS TO QUALITY CONTROL FINISHED BOXES AS OPTION
- COMPACT FOOTPRINT

Exclusive distributor
for North America



IMA  **E-COMMERCE**
Advanced Packaging Solutions

TECHNICAL DATA

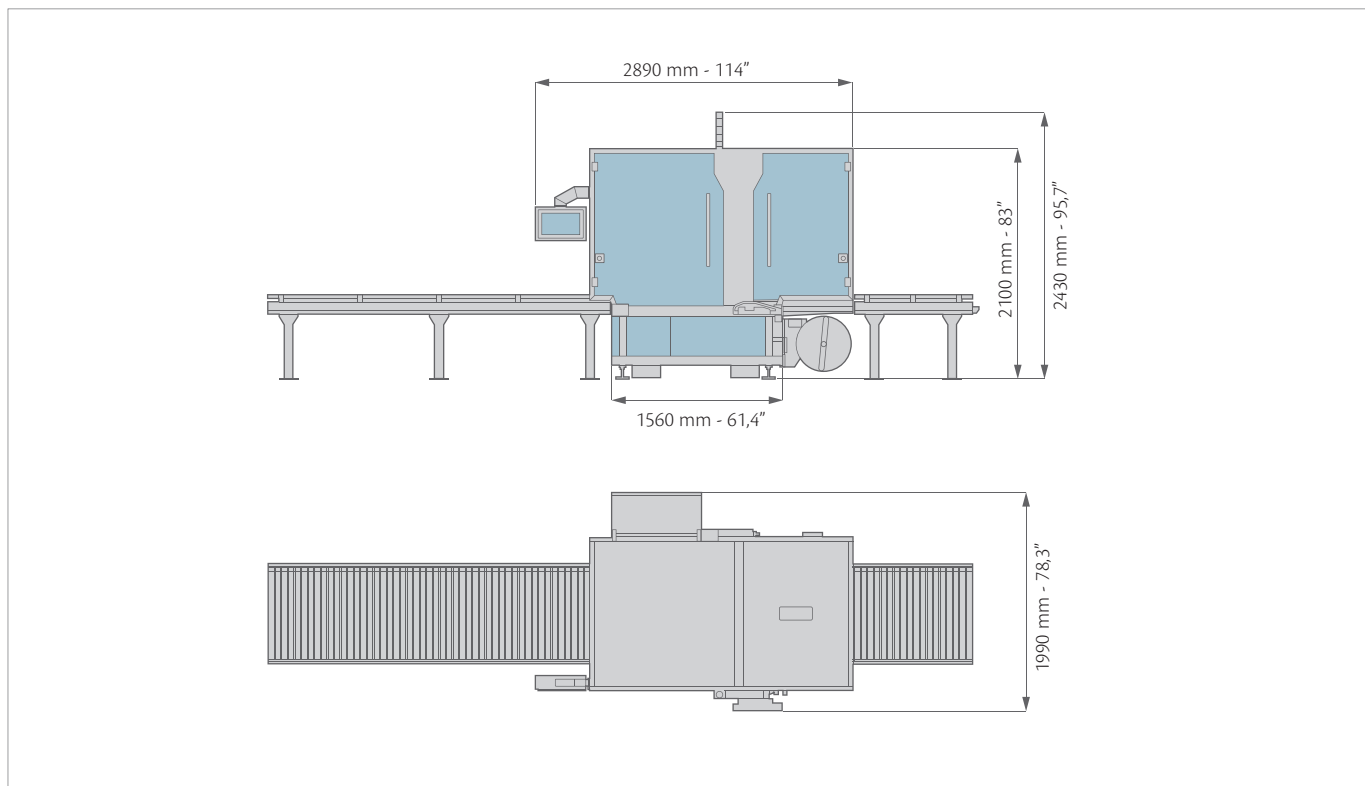

Machine Dimensions	114" x 78,3" x min. 83" (2890 mm x 1990 mm x min. 2100 mm)**
Machine weight	1360 kg
Throughput in cases/minute	Box: 11-18 box/min Ships In Own Container (SIOC): up to 20 box/min
Box Type	Taping function: preformed box with flaps open in the upper side Bypass function: for SIOC and boxes already taped.
Min Case Size (Internal dimensions)	7" x 6" x 3" (18 cm x 15 cm x 8 cm)
Min Case Size SIOC	7" x 6" x 3" (18 cm x 15 cm x 8 cm)
Max Case Size	40" x 28,5" x 16" (102 cm x 72 cm x 40 cm) (It is possible to process boxes with 16" < H < 19" only if (H+W/2) < 30,5")
Max Case Size SIOC	∞" x 29,2" x 19" (∞ cm x 74 cm x 48 cm)
Bypass Feature	Yes
Low Tape/No Tape Monitor	Yes
Low Water Monitor	Yes
Case Weight	Max 35 KG
Tape Width	70 to 75 mm
Operator Free	Yes
Optional Kick Out Feature	Yes

** The machine requires minimum 61,5" (156 cm) as space between the conveyors, while the additional part must be considered as space occupied on top of them; the height is adjustable to the infeed and exit conveyors, which must be the same.

