

Pepsi, USA: Increased storage capacity by 61.5%

The Customer and Their Requirements

Pepsi Bottling Ventures in Garner, NC has installed the Swisslog PowerStore pallet shuttle warehouse automation. This technology has increased storage capacity by over 60% in the existing building of the nation's largest privately-held manufacturer, seller, and distributor of Pepsi-Cola beverages.

PowerStore enabled Pepsi Bottling Ventures to:

- Seamless distribution of 7,800 pallets
- Double layer induction/deduction for ease of use by lift drivers increase throughput and employee productivity
- Seamlessly integrate software with existing ERP system

Swisslog designed and implemented the Batesville distribution center using advanced warehouse execution software (WES) to help workers quickly and accurately pick and pack orders.

SWISSLOG

161 Enterprise Drive, Newport News, VA 23603
+1 757 887 8080
infona@swisslog.com
www.Swisslog.com

“An overall traditional expansion would have been less desirable because it builds in permanent, long-term inefficiencies through greater fork-lift travel time and facility heating and cooling costs.”

- Matthew Bucherati, SVP Operations, Pepsi Bottling Ventures

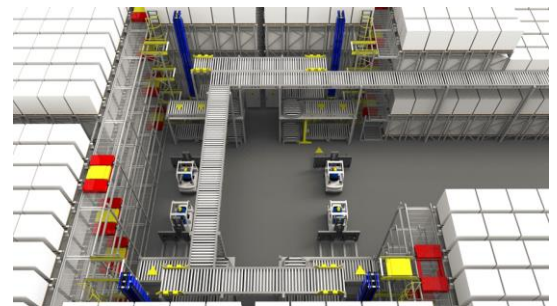

Growth & Impact



Seamless Distribution
7,800 Pallet positions



Increase in Storage
61.5% storage capacity increase



Consistency
Handles a variety of SKU volume and cold-storage picking & pack-out stations