

CASE STUDY
BASTIAN SOLUTIONS

An Engineering Feat and an Industry First

“We’ll come up with something.” That’s what Bastian Solutions, a Toyota Advanced Logistics company, said to the customer when asked to engineer a stacker crane for a new automated warehouse. Bastian Solutions’ response belied the magnitude of the challenge.

The automated stacker crane is a central component of the customer’s new automated storage and retrieval system (AS/RS). It swiftly transfers packages of fiber cement boards from an immense racking system to workers at ground level. The boards are over 12 feet long and weigh 12,000 pounds per package. (Typical crane loads are 2,000 to 3,000 pounds.)

Bastian Solutions knew a standard crane just wouldn’t cut it. It couldn’t be a scaled up version of a smaller crane. In fact, the specifications for this crane were so demanding, the safety, mechanical and structural analysis was in design for almost two years.

- The racking system for the AS/RS had to be built around the crane
- The crane couldn’t be attached to the top of the building, because it could potentially take down the entire building
- Multiple points of redundancy needed to be accommodated to meet safety

**Bastian**
SOLUTIONS

a TOYOTA ADVANCED LOGISTICS company

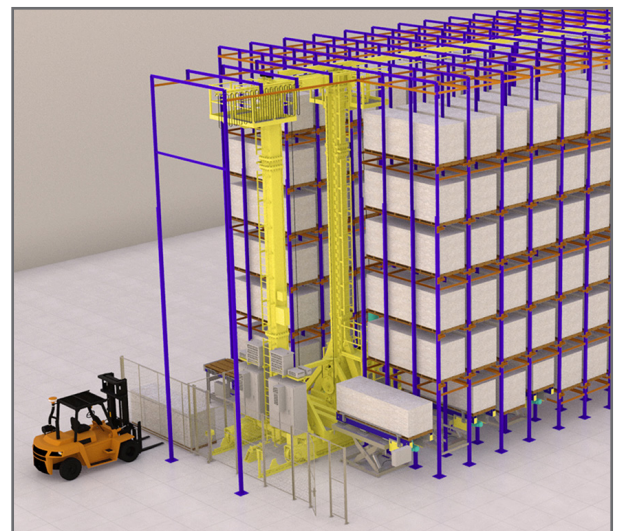

The stacker crane is 45 feet tall, 12 feet wide, and over 15 feet deep.

It's Like Lifting Five Toyota Sequoia SUVs

The density and length of the load made drive selection and torque outputs challenging to say the least. The end user specified a Mitsubishi Electric control system, but Bastian Solutions selected Mitsubishi Electric for the drive components.

A specialized automated warehouse drive was just being introduced to the U.S. market and Mitsubishi Electric distributor, Allied Automation was more than happy to provide it. Allied Automation also brought in a third-party provider, SICK Sensor Intelligence, for the crane's dual-laser distance sensor. That meant the drive had to interface with the laser feedback device.

Bastian Solutions would be one of the first in the industry to benefit from the industry-leading performance and built-in functionality of the new drive. The crane-specific capabilities included load slippage prevention and anti-sway control for automatic suppression of swinging objects as they're being moved by the crane — without any adjustment by the operator.

The crane would be lifting the equivalent of five Toyota Sequoias throughout the day. The size, shape and weight of the load necessitated two vertical axes and two horizontal axes. The project engineer Tom Palcheck says, "We had to have multiple drives per axis working in coordinated motion to make it work." And while some crane functionality was already engineered into the drive, there was a fair amount of custom firmware required.

Bastian Solutions got a lot of support from Mitsubishi Electric field application engineers. Tom says, "They went right to work, making the firmware changes that would allow us to do what was required." They added:

- Droop control to accommodate the dual pulleys on the crane assembly for the large payload
- Horizontal sway control to make sure the load stayed level
- Dual-laser position control of the vertical axis to provide precise positioning measurement in a matter of milliseconds

"Bastian Solutions got a lot of support from Mitsubishi Electric field application engineers. They went right to work, making the firmware changes that would allow us to do what was required."

Tom Palcheck
– Project Engineer
Bastian Solutions





“When you’re lifting 12,000 pounds, you’re going to have problems. There will be skewing. We had access to the engineers that developed the hardware. We overcame challenges together. Mitsubishi Electric was right there all the time.”

Tom Palcheck
– Project Engineer
Bastian Solutions

A Crane That Stands Alone

Typically, the crane would be controlled by the Warehouse Control System (WCS). In this case, the crane was designed as a standalone system. All the intelligence is built into the drive to ensure a true representation of where the crane is at all times. The drive communicates to the main PLC over a CC-Link IE Field Safety Network.

This was an important part of the design, because there are two sources of feedback for the crane: the laser and the motor. Both had to be taken into consideration. It made sense to do it in the drive because it simplified the design. There was:

- Less programming
- Improved performance
- Better accuracy

During the Factory Acceptance Test, the stacker crane met performance criteria with flying colors, achieving full-speed and full load results. (The site acceptance test went just as well.) This was definitely the biggest crane Bastian Solutions has ever built. Their customer now has an automated crane that:

- Keeps track of where products are stored
- Shares information with an external system
- Handles heavy loads, but retains the accuracy, safety, performance and functionality expected of smaller cranes

There is tremendous potential to use this stacker crane for other projects in other industries like Automotive and Aerospace. It opens up a fairly big and underserved market for Bastian Solutions. That truly is an engineering feat.



AUTOMATION SOLUTION INGREDIENTS

- MELSEC iQ-R Series Programmable Controllers
- CC-Link IE Field Network
- FR-A800 Plus Inverters (VFD)
- CC-Link Digital Remote I/O Modules



a TOYOTA ADVANCED LOGISTICS company

Learn more about Bastian Solutions:
BastianSolutions.com

NEXT STEPS

For more information or a free consultation with an automation engineer, please

[> Connect with Us](#)

MITSUBISHI ELECTRIC AUTOMATION, INC.

500 Corporate Woods Parkway, Vernon Hills, IL 60061
Ph 847.478.2100 • Fx 847.478.2253

[us.MitsubishiElectric.com/fa/en](https://us.mitsubishielectric.com/fa/en)

February 2021 • ©2021, Mitsubishi Electric Automation, Inc.
Specifications subject to change without notice. • All rights reserved

CS-VH-00146